

Installation instruction

1. Installation position and configuration of hinges

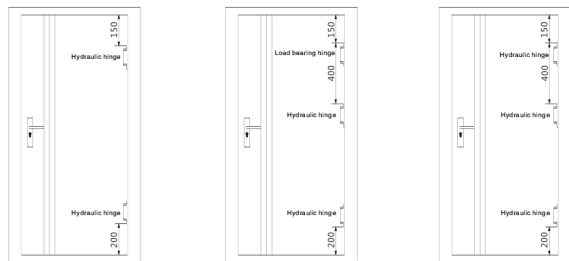

| Door weight | Door width dimension | quantity | notes |
|-------------|----------------------|-----------------------------|---------------------------------------|
| ≤60KG | ≤2000mmX900mm | 2 hydraulic hinges | Over 2100mm with 1 load-bearing hinge |
| ≤80KG | ≤2400mmX900mm | 2 hydraulic+ 1 load-bearing | |
| ≤80KG | 2400≤2800mmX900mm | 3 hydraulic hinges | |

2. Functional diagram:

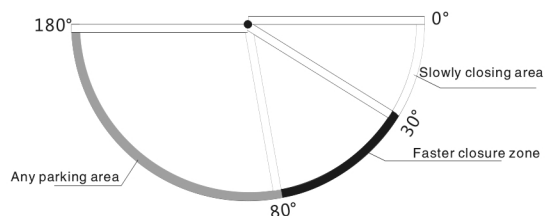

※ Function Description

1. Installation is not divided into left and right, with automatic hydraulic buffer closing.
2. The maximum angle for one-way door opening is 180°.
3. Door closing angle: any angle between 80° and 180°. If it is below 80°, the door will automatically close, and if it is below 30°, it will slowly close.
4. Adjustable closing speed.
5. 3D adjustable: adjustable up and down, left and right, and front and back.

3. Size diagram of slotting on the door

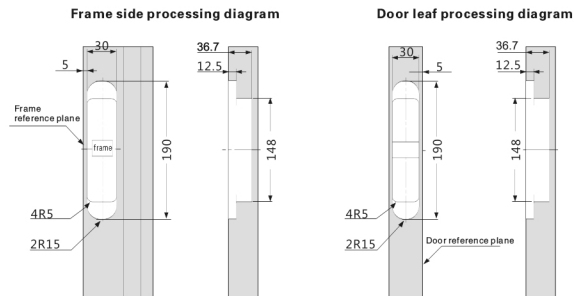

Special attention: The slot is 5mm away from the edge

4. Installation diagram

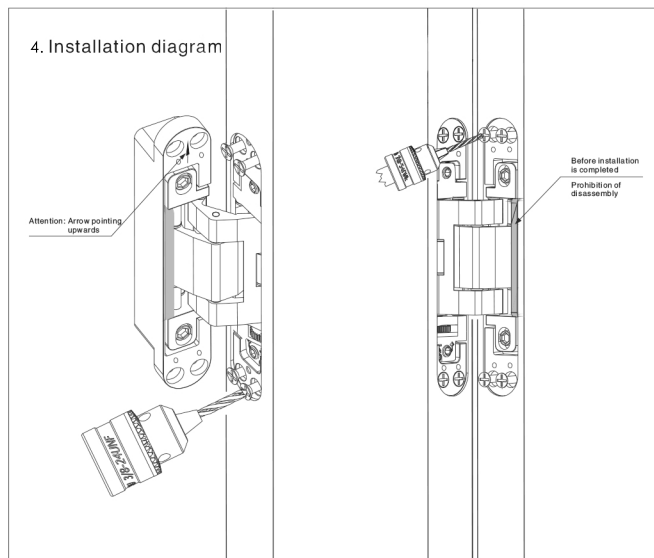

5. Hinge adjustment

(up and down, left and right, front and back adjustment)

